

DRAFT

MAIN CHANNEL

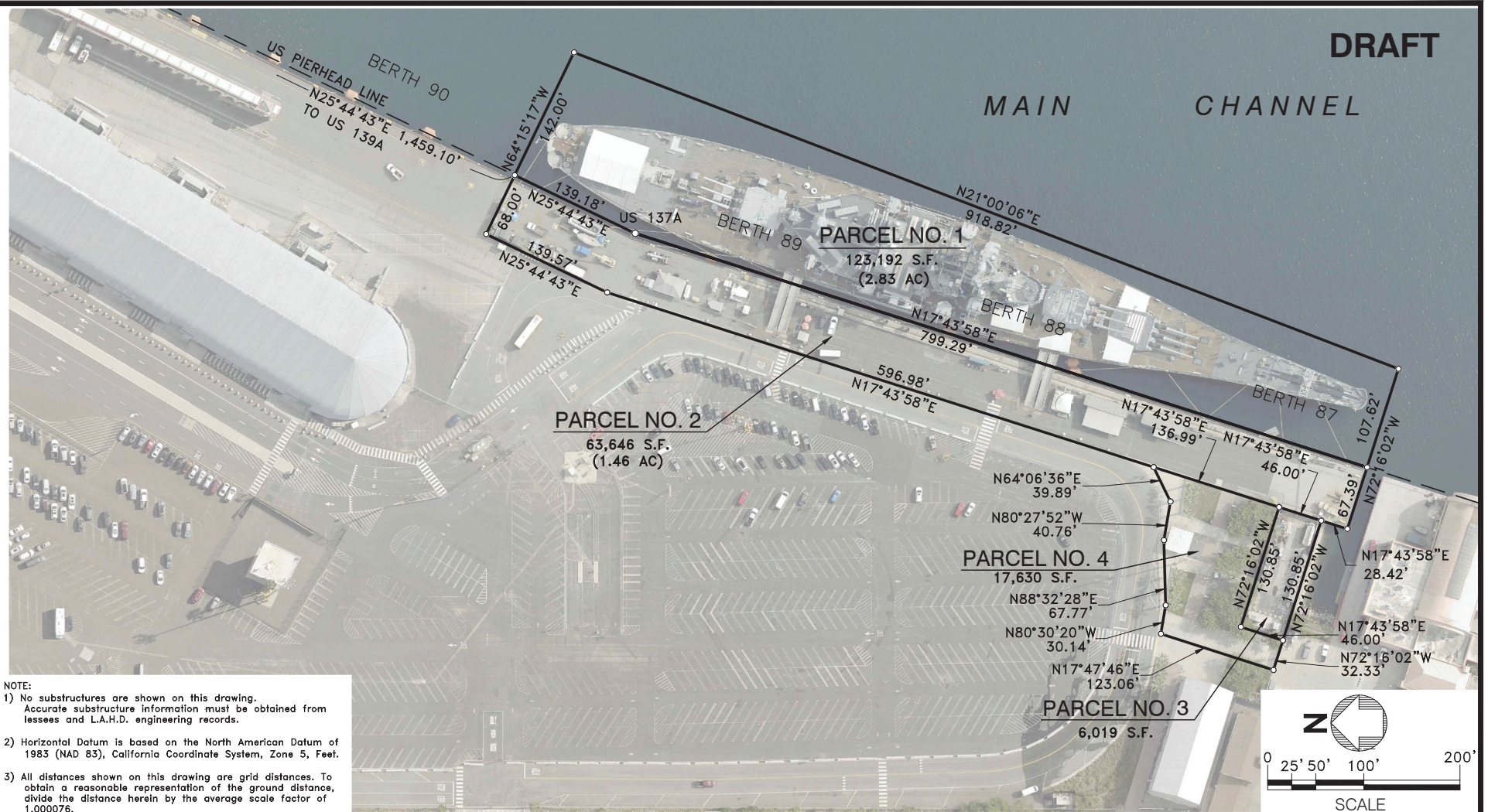

NOTE:
 1) No substructures are shown on this drawing. Accurate substructure information must be obtained from lessees and L.A.H.D. engineering records.
 2) Horizontal Datum is based on the North American Datum of 1983 (NAD 83), California Coordinate System, Zone 5, Feet.
 3) All distances shown on this drawing are grid distances. To obtain a reasonable representation of the ground distance, divide the distance herein by the average scale factor of 1.000076.

DWG: N:\aerial\maps\45638\REV1_2024-02-22.dwg USER: HANVCP
 DATE: May 22, 2024 3:50pm XREFS: BDRY-PAR_887.dwg IMAGES: I:\447_17294\16_0471_17294\16_0471_17294\16_0471_17294.dwg
 PLOT: 45638.DWG

NO.	DATE	DRAWN	REVISIONS -	CH'KD	APP'D	SCALE: 1" = 100'	CHIEF OF DESIGN	PERMIT MAP - AUTHORITY NO. P899
1	5/24	RH	ADDED PARCEL NO. 4			DRAWN: C. VENTURA CHECKED: D. RAASCH DESIGNED: E. KHALVATI ENGR/ARCH	ASSISTANT CHIEF OF HARBOR ENGINEER	
							CHIEF OF HARBOR ENGINEER DATE	DRAWING NUMBER 45638

**THE PORT OF LOS ANGELES
 ENGINEERING DIVISION**
 425 S. PALOS VERDES STREET SAN PEDRO CA 90731-3309