

Appendix H

MOU Accounting for Mitigation Bank

FILE

Date: August 12, 1998

S. Palms Verdes Street

To: Distribution

Office Box 151

SUBJECT: INNER HARBOR MOU ACCOUNTING AND AMENDMENT

Pedro, CA 90733-0151

DD 310 SEA-PORT

portla.com

In 1984 the Los Angeles Harbor Department entered into a Memorandum of Understanding (MOU) with your agency to establish procedure for advance compensation of marine habitat losses incurred by selected Port development projects within the Harbor District of the City of Los Angeles. The purpose of this letter is to update the accounting on the MOU and to request your concurrence to add an additional project to the MOU.

At the writing of the MOU, there was a credit in the mitigation bank of 17.7 acres measured at +4.8 MLLW. Since that time, the Port has made withdrawals and additions associated with four projects as shown below leaving a balance of +6.21 acres:



Richard J. Riordan, Mayor
of Los Angeles

Board of Harbor
Commissioners

Richard Wong, President

Carol L. Rowan, Vice President

Dr. M. Sanchez, Ph.D.

William Y. Thomas

William M. Wilson

John A. Keller
Executive Director

<u>Project</u>	<u>Status</u>	<u>Debit/Credit (acres)</u>	<u>Balance (acres)</u>	<u>Reference</u>
			+17.70	MOU
• Berth 225-229	Constructed	-5.91	+11.79	POLA Letter 9/94
• Berth 212-215	Constructed	-11.09	+00.70	POLA Letter 9/94
• Fire Station 111	Constructed	-0.21	+00.49	POLA Letter 9/94
• Fire Station 112	Constructed	+0.02	+00.51	POLA Letter 9/94
• W. Basin Widen.	Constructed	+5.70	+06.21	Attachment A

We also anticipate an additional project which will decrease the water area of the harbor:

<u>Project</u>	<u>Status</u>	<u>Project Type</u>	<u>Reference</u>
• W.Channel Dev.	Planning/Env.	~4.4 acre fill	Attachment B

In accordance with Article 5 of the MOU, "The BOARD may accrue gains in marine habitat values resulting from Harbor District development projects which create water surface area." In this regard, we would like your written concurrence to add the West Channel Project to the bank listing pending a favorable environmental review and permitting process. An Environmental Impact Report is presently being prepared for this project.

We appreciate your attention to this very important matter. If you have any questions or comments, please do not hesitate to call me at (310) 732-3497.

Sincerely,

RALPH G. APPY, Ph.D.
Assistant Director of Environmental Management

RG
ADP 870324-034

Distribution: U.S Fish and Wildlife Service - Attention : Mr. Jack Fancher
National Marine Fisheries Service - Attention : Mr. Bob Hoffman
California Department of Fish and Game - Attention : Ms. Marilyn Fluharty

bcc: Engineering/B. McCleish
Engineering/M. Rowghani
Environmental/V. Amezcuita

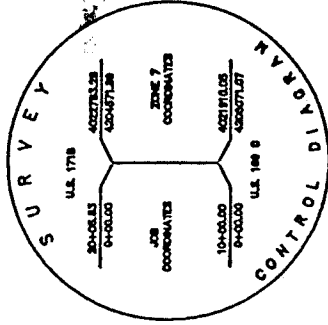

WEST BASIN ENTRANCE WIDENING - CREATION OF NEW WATER AREA BY WIDENING THE CHANNEL ENTRANCE, MEASURED AT THE MEAN HIGH WATER LEVEL (+4.8 FEET MEAN LOWER LOW WATER)

AREA CALCULATION:
 AREA = 1/2 BASE X HEIGHT
 = 1/2 X 1037 X 475/43,560
 = 5.65 ACRES

5.74 ACRES COMPUTER CALC.

NEWLY CREATED WATER AREA = 5.7 ACRES

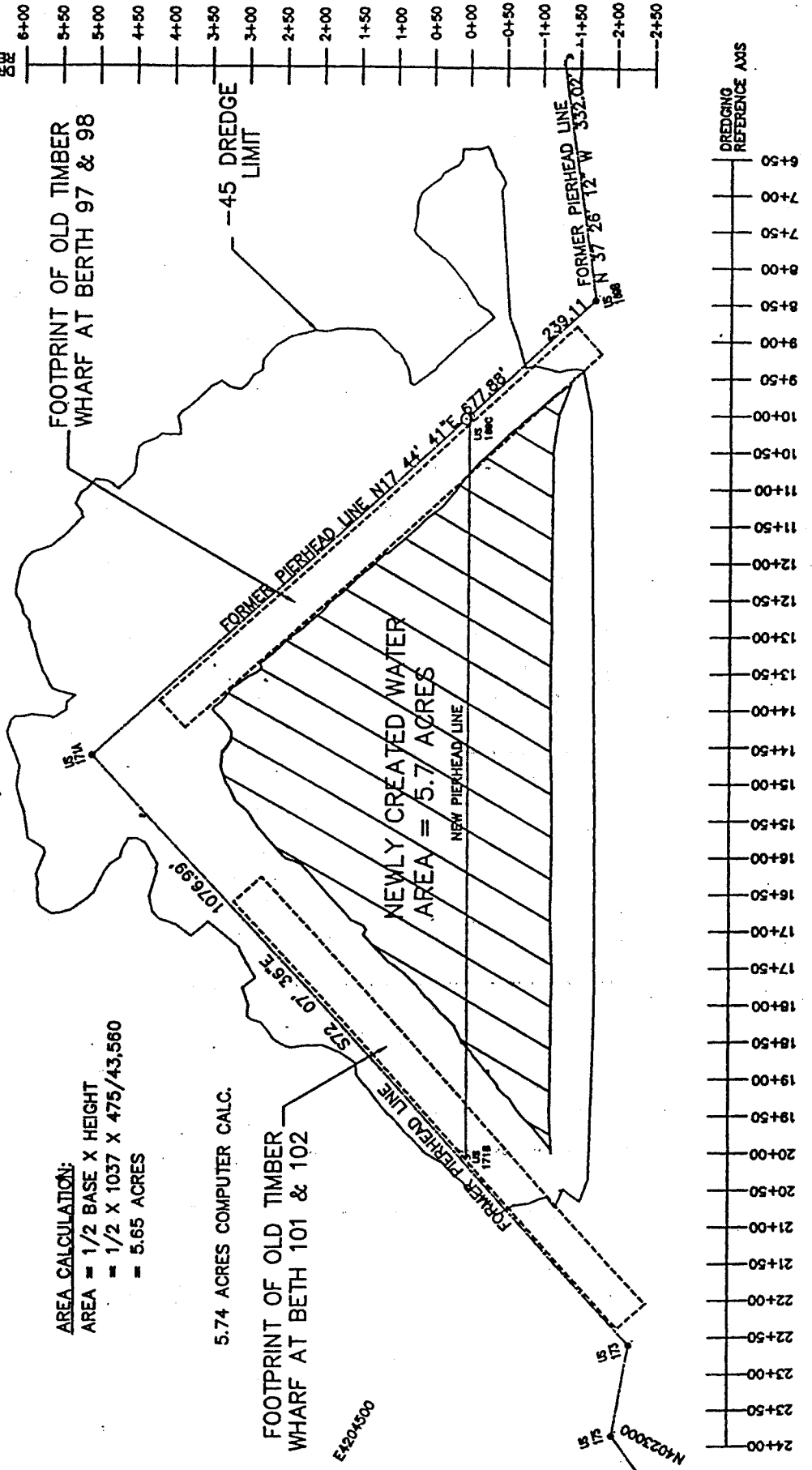

SCALE NOT TO SCALE	RECOMMENDING FOR APPROVAL	AS-BUILT HABITAT CALCULATION/WEST BASIN ENTRANCE WIDENING PROJECT	
DRAWN N. DEAL	CHIEF OF DESIGN	LOS ANGELES HARBOR, COUNTY OF LOS ANGELES STATE OF CALIFORNIA APPLICATION BY PORT OF LOS ANGELES	
CHECKED M. ROWGHANI	ASSISTANT CHIEF HARBOR ENGINEER N/A	APPROVED:	DRAWING NUMBER 5-7160-10
DESIGNED A. LIM		CHIEF HARBOR ENGINEER	
ENCR/ARCH		WORLDPORT LA ENGINEERING DIVISION P.O. BOX 181 SAN PEDRO, CALIF.	

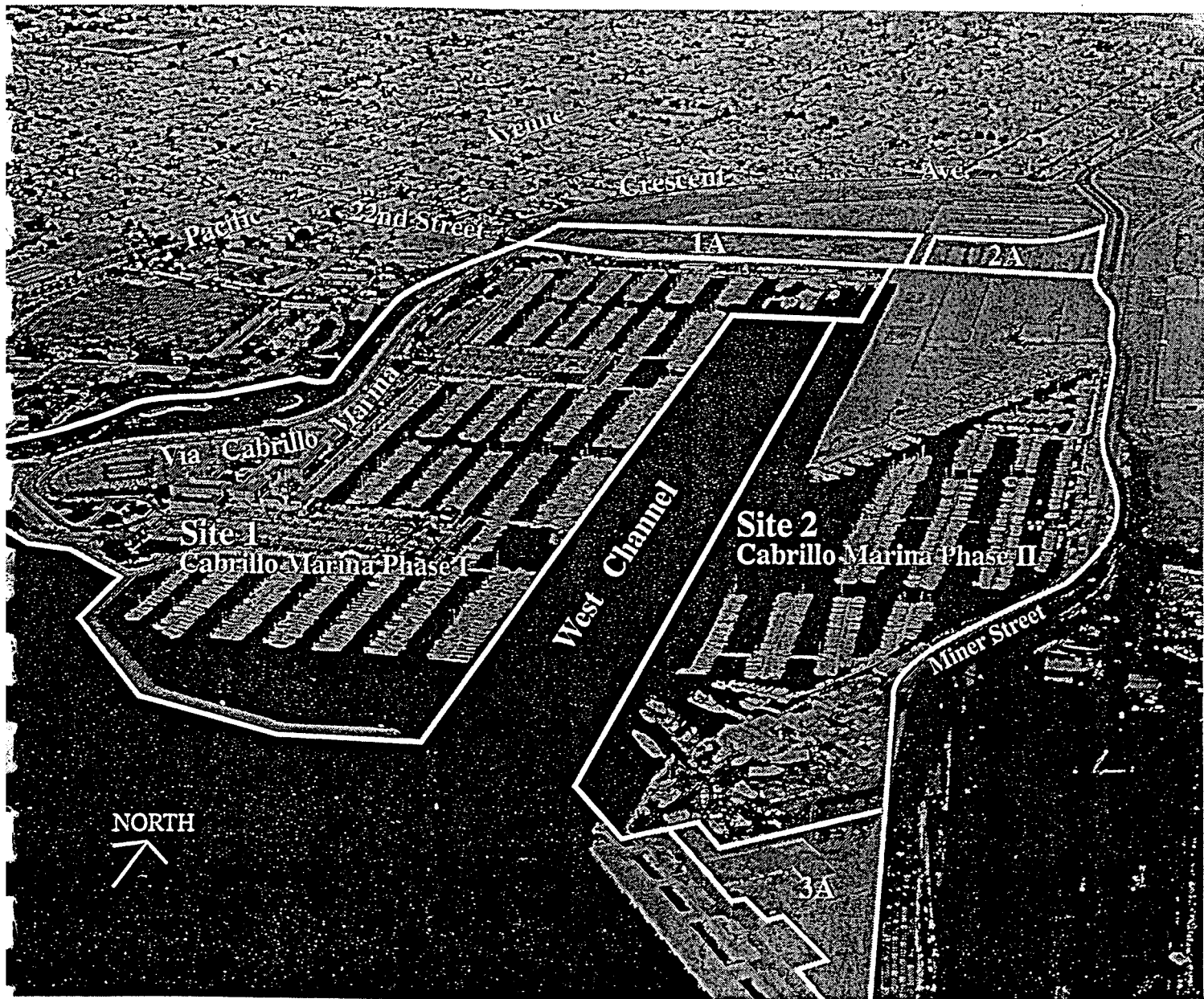

CUT AREA

① 0.6 AC ② 0.5 AC

TOTAL = 1.1 AC

TOTAL CUT VOLUME = 40,000 CY

FILL AREA

③ 1.2 AC ⑤ 3.3 AC

④ 1.0 AC

TOTAL = 5.5 AC

TOTAL FILL VOLUME = 185,000 CY

DREDGING AREA

TOTAL = 9.6 AC ⑥

TOTAL DREDGE VOLUME = 75,000 CY

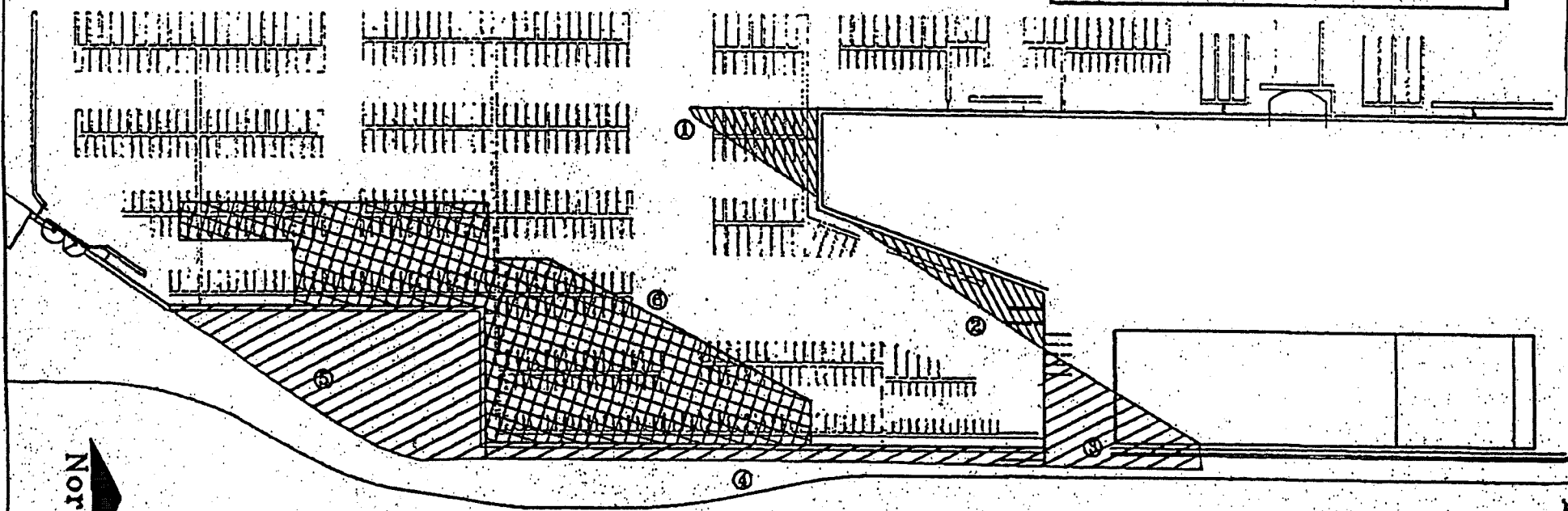

• MATERIALS EXTRACTED FROM CUT/DREDGED AREAS ARE TO BE USED IN THE FILL PORTION OF THE SITE

CUT/FILL/DREDGING MARKUP
CABRILLO WAY AT
CABRILLO YACHT HARBOR

ATTACHMENT B