

SHED	AREA
BERTH 57	46,500 S.F.
BERTH 58	58,850 S.F.
BERTH 59	60,150 S.F.
BERTH 60	60,000 S.F.

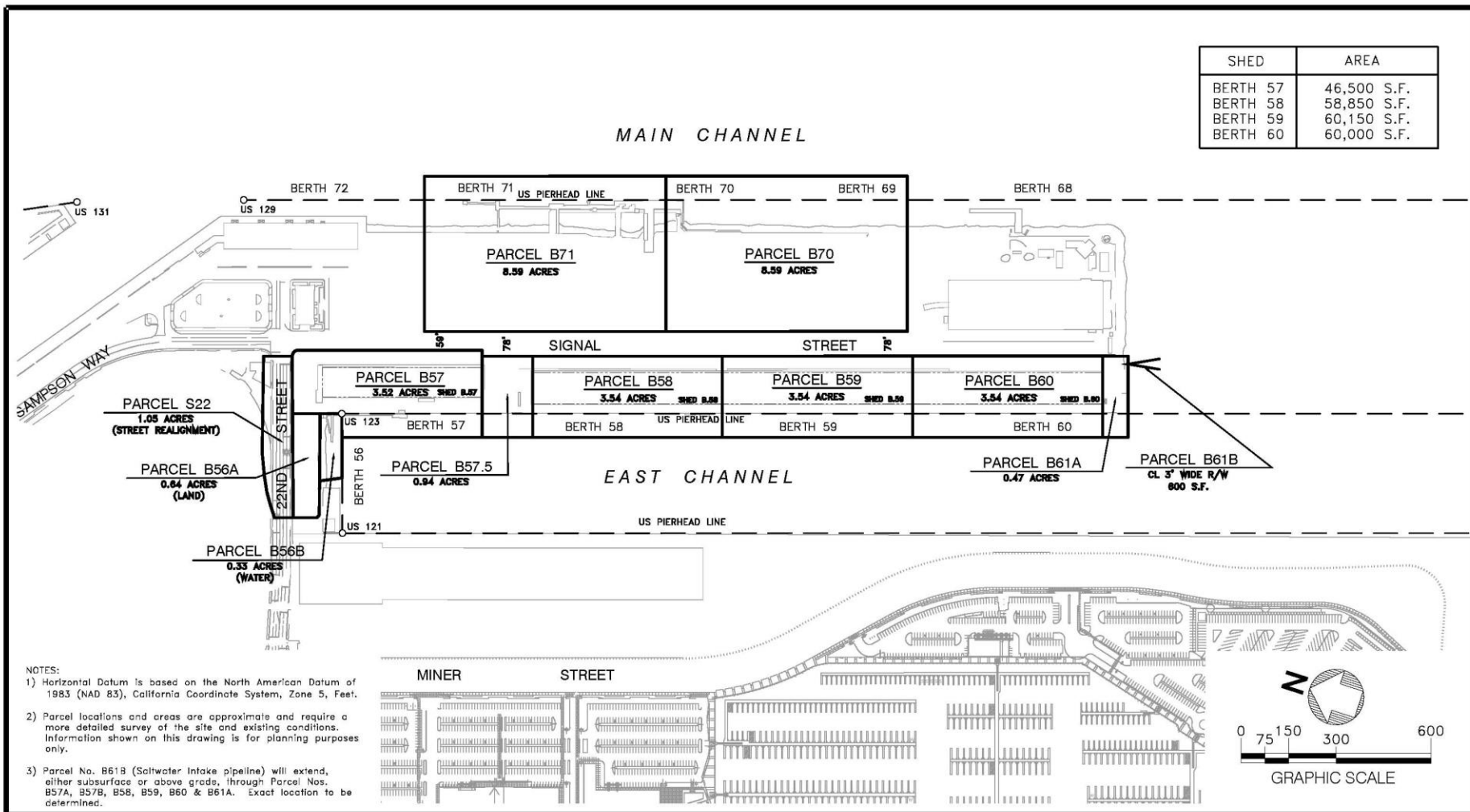

NOTES:
 1) Horizontal Datum is based on the North American Datum of 1983 (NAD 83), California Coordinate System, Zone 5, Feet.
 2) Parcel locations and areas are approximate and require a more detailed survey of the site and existing conditions. Information shown on this drawing is for planning purposes only.
 3) Parcel No. B61B (Saltwater Intake pipeline) will extend, either subsurface or above grade, through Parcel Nos. B57A, B57B, B58, B59, B60 & B61A. Exact location to be determined.

NO.	DATE	DRAWN	REVISIONS -	CH'KD	APP'D	SCALE: 1" = 300'	RECOMMENDED FOR APPROVAL	Permit Map - Amended and Restated Lease No. 904
1	07/17	DRR	REVISED AND RENUMBERED PARCELS			DRAWN: DRR 9/13 CHECKED: C. GROSSI 9/13 DESIGNED: D. RAASCH 9/13 ENGR/ARCH <i>Daryl R. Raasch</i>	CHIEF OF DESIGN <i>Mark Rough</i> ASSISTANT CHIEF HARBOR ENGINEER <i>Debra M. Wall</i>	ALTASEA - MARINE RESEARCH CENTER APPROVED <i>Antonio Gioiello</i> CHIEF HARBOR ENGINEER
							THE PORT OF LOS ANGELES ENGINEERING DIVISION 425 S. PALM STREET SAN PEDRO CA 90731-3200	DRAWING NUMBER 45640