

The Port of Los Angeles
UTILITY AGREEMENT

<i>County</i>	<i>Route</i>	<i>P.M.</i>	<i>Project #</i>
<i>Los Angeles</i>	<i>I-110</i>	<i>2.5/3.0</i>	<i>0700000494</i>
<i>Fed Aid No. STPL-5006761</i>			
<i>Owner's File No. 8702670 (A4-03)</i>			
FEDERAL PARTICIPATION:			
<i>On the Project: Yes</i>			
<i>On the Utilities: No</i>			

UTILITY AGREEMENT NO. 07-UT-12-3880

The Port of Los Angeles, acting by and through the Board of Harbor Commissioners "LOCAL AGENCY" proposes the Interchange Improvements project, in the City of Los Angeles on Interstate 110 from 0.30 miles south of C Street to 0.20 miles north of C Street, in Los Angeles County.

And: Pacific Bell Telephone Company dba AT&T California
600 East Green Street, Room 300
Pasadena, CA 91101

Hereinafter called "OWNER," owns and maintains communication facilities "FACILITIES" within the limits of LOCAL AGENCY'S project that requires relocation of said facilities, in order to accommodate LOCAL AGENCY's project, as described in Exhibit A (OWNER's Relocation Description).

It is mutually agreed that:

I. WORK TO BE DONE

OWNER shall relocate OWNER'S fiber optic facilities in accordance with Notice to Owner No. 12-3880 dated December 24, 2012, and in accordance with Exhibit C (OWNER's Utility Plan No. 8702670 dated June 18, 2014) which supersedes Exhibit B (OWNER's Utility Plan No. 8702670 dated November 27, 2012). Deviations from the OWNER's plan described above initiated by either the LOCAL AGENCY or the OWNER, shall be agreed upon by both parties hereto under a Revised Notice to Owner. Such Revised Notices to Owner, approved by the LOCAL AGENCY and agreed to/acknowledged by the OWNER, will constitute an approved revision of the OWNER's plan described above and are hereby made a part hereof. No work under said deviation shall commence prior to written execution by the OWNER of the Revised Notice to Owner. Changes in the scope of the

work will require an amendment to this Agreement in addition to the revised Notice to Owner.

II. LIABILITY FOR WORK

The existing facilities described in Section I above will be relocated at 50% LOCAL AGENCY expense and 50% OWNER's expense after application of credits in accordance with Section 5 of the Master Freeway Contract dated November 1, 2004.

III. PERFORMANCE OF WORK

OWNER agrees to perform the herein described work with its own forces or to cause the herein described work to be performed by the OWNER's contractor, employed by written contract on a continuing basis to perform work of this type, and to provide and furnish all necessary labor, materials, tools, and equipment required therefore, and to prosecute said work diligently to completion.

Use of out-of-state personnel (or personnel requiring lodging and meal "per diem" expenses) will not be allowed without prior written authorization by LOCAL AGENCY's representative. Requests for such authorization must be contained in OWNER's estimate of actual and necessary relocation costs. Accounting Form FA-1301 is to be completed and submitted for all non-LOCAL AGENCY personnel travel per diem. OWNER shall include an explanation why local employee or contract labor is not considered adequate for the relocation work proposed. Per diem expenses shall not exceed the per diem expense amounts allowed under the LOCAL AGENCY's Department of Personnel Administration travel expense guidelines.

Pursuant to Public Works Case No. 2001-059, determination by the California Department of Industrial Relations dated October 25, 2002 work performed by OWNER's contractor is a public work under the definition of Labor Code Section 1720(a) and is therefore subject to prevailing wage requirements. OWNER shall verify compliance with this requirement in the administration of its contracts referenced above.

Engineering services for locating, making of surveys, preparation of plans, specifications, estimates, supervision, and inspection are to be furnished by the Utility Owner and approved by the LOCAL AGENCY. Cost principles for determining the reasonableness and allowability of OWNER's costs shall be determined in accordance with 48 CFR, Chapter 1, Part 31; 23 CFR, Chapter 1, Part 645; and 18 CFR, Chapter 1, Parts 101, 201 and OMB Circular A-87, as applicable.

IV. PAYMENT FOR WORK

The LOCAL AGENCY shall pay its share of the actual and necessary cost of the herein described work within 45 days after receipt of five (5) copies of OWNER's itemized bill, signed by a responsible official of OWNER's organization and prepared on OWNER's letterhead, compiled on the basis of the actual and necessary cost and expense incurred and charged or allocated to said work in accordance with the uniform system of accounts prescribed for OWNER by the California Public Utilities Commission, Federal Energy

Regulatory Commission or Federal Communications Commission, whichever is applicable.

It is understood and agreed that the LOCAL AGENCY will not pay for any betterment or increase in capacity of OWNER's facilities in the new location and that OWNER shall give credit to the LOCAL AGENCY for the "used life" or accrued depreciation of the replaced facilities and for the salvage value of any material or parts salvaged and retained or sold by OWNER.

Not more frequently than once a month, but at least quarterly, OWNER will prepare and submit progress bills for costs incurred not to exceed OWNER's recorded costs as of the billing date less estimated credits applicable to completed work. Payment of progress bills not to exceed the amount of this Agreement may be made under the terms of this Agreement. Payment of progress bills which exceed the amount of this Agreement may be made after receipt and approval by LOCAL AGENCY of documentation supporting the cost increase and after an Amendment to this Agreement has been executed by the parties to this Agreement.

The OWNER shall submit a final bill to the LOCAL AGENCY within 180 days after the completion of the work described in Section I above. If the LOCAL AGENCY has not received a final bill within 180 days after notification of completion of OWNER's work described in Section I of this Agreement, and LOCAL AGENCY has delivered to OWNER fully executed Director's Deeds, Consents to Common Use or Joint Use Agreements as required for OWNER's facilities; LOCAL AGENCY will provide written notification to OWNER of its intent to close its file within 30 days and OWNER hereby acknowledges, to the extent allowed by law that all remaining costs will be deemed to have been abandoned.

The final billing shall be in the form of an itemized statement of the total costs charged to the project, less the credits provided for in this Agreement, and less any amounts covered by progress billings. However, the LOCAL AGENCY shall not pay final bills, which exceed the estimated cost of this Agreement without documentation of the reason for the increase of said cost from the OWNER. If the final bill exceeds the OWNER's estimated costs solely as the result of a revised Notice to Owner as provided for in Section I, a copy of said revised Notice to Owner shall suffice as documentation.

In any event if the final bill exceeds 125% of the estimated cost of this Agreement, an amended Agreement shall be executed by the parties to this Agreement prior to the payment of the OWNER's final bill. Any and all increases in costs that are the direct result of deviations from the work described in Section I of this Agreement shall have the prior concurrence of LOCAL AGENCY.

Detailed records from which the billing is compiled shall be retained by the OWNER for a period of three years from the date of the final payment and will be available for audit in accordance with Contract Cost Principals and Procedures as set forth in 48 CFR, Chapter 1, Part 31 by LOCAL AGENCY and/or Federal Auditors.

V. GENERAL CONDITIONS

All costs accrued by OWNER as a result of LOCAL AGENCY's request of December 24, 2012 to review, study and/or prepare relocation plans and estimates for the project associated with this Agreement may be billed pursuant to the terms and conditions of this Agreement. The estimated cost to the CITY for its share of the above described work is \$262,047.

If LOCAL AGENCY's project which precipitated this Agreement is canceled or modified so as to eliminate the necessity of work by OWNER, LOCAL AGENCY will notify OWNER in writing and LOCAL AGENCY reserves the right to terminate this Agreement by Amendment. The Amendment shall provide mutually acceptable terms and conditions for terminating the Agreement.

All obligations of LOCAL AGENCY under the terms of this Agreement are subject to the passage of the annual Budget Act by the State Legislature and the allocation of those funds by the California Transportation Commission.

OWNER shall submit a Notice of Completion to the LOCAL AGENCY within 30 days of the completion of the work described herein.

It is understood that said highway is a Federal aid highway and accordingly, 23 CFR, Chapter 1, Part 645 and 23 U.S.C., section 313 as applicable, is hereby incorporated into this Agreement by reference; provided, however, that the provisions of any agreements entered into between the LOCAL AGENCY and the OWNER pursuant to State law for apportioning the obligations and costs to be borne by each, or the use of accounting procedures prescribed by the applicable Federal or State regulatory body and approved by the Federal Highway Administration, shall govern in lieu of the requirements of said 23 CFR 645.

The Buy America requirements are further specified in Moving Ahead for Progress in the 21st Century (MAP-21), section 1518.

OWNER hereby certifies that all manufacturing processes for these steel and iron materials, including the application of coatings (unless granted a waiver pursuant to 23 CFR 635.410), have occurred in the United States.

If the project does not have NEPA clearance, the "Buy America" requirements do not apply and the above clauses are not applicable. However, utility work that is accomplished through utility agreements that do not comply with the Buy America requirements (as specified in 23 U.S.C. 313 and 23 CFR 635.410) cannot be used to meet the non-Federal share of costs for a project that uses Federal funds.

IN WITNESS WHEREOF, the above parties have executed this Agreement the day and year written below.

**CITY OF LOS ANGELES
HARBOR DEPARTMENT, by its
Board of Harbor Commissioners**

By _____
EUGENE D. SEROKA
Executive Director

DATED: _____

Attest: _____
Board Secretary

**PACIFIC BELL TELEPHONE COMPANY
dba AT&T CALIFORNIA**

By: _____
John P. Johnston, Area Manager
Print Name and Title of Officer

DATED: 4/2/15

Attest: _____
Rebecca Harris, ROW Manager
Print Name and Title of Officer

APPROVED AS TO FORM
April 24, 2015
MICHAEL N. FEUER, City Attorney
Janna B. Sidley, General Counsel

By: _____
ESTELLE BRAAF, Deputy City Attorney

Account#	5450	W.O. #	24862-00
Ctr/Div #	1172	Job Pac. #	250-1100
Proj/Prog#	000		
Budget FY:		Amount:	
	15/16		262,047
TOTAL			262,047

For Acct/Budget Div. Use Only
 Verified by: _____
 Verified Funds Available: _____
 Date Approved: _____
 4/14/2015

Enclosures:

- Exhibit A: OWNER's Relocation Description
- Exhibit B: OWNER's Utility Plan No. 8702670 dated November 27, 2012
- Exhibit C: OWNER's Utility Plan No. 8702670 dated June 18, 2014

Exhibit A

OWNER's Relocation Description

Interchange Improvements Project
I-110 0.3 miles s/o C Street to 0.20 miles n/o C Street
Los Angeles County

Install one new utility pole and five new manhole structures and adjust one manhole to grade. Install 1,508 linear feet of four (4)-4" ducts underground. Install 595 linear feet of two (2)-4" ducts underground. Remove two service boxes and abandon one utility pole, one manhole, approximately 1,322 linear feet of various sizes ducts and buried cables.

CONSTRUCTION NOTES

Proposal as per Caltrans/POLA request on EA264801 to relocate Telco Plant. AT&T to relocate conduit, manholes, poles, cables, perform splicing activity and associated Telco plant removal. Construction temp trailer located around 251 Figueroa to disconnect/relocate service prior to AT&T relocation. JPA pending with LADWP. Caltrans/POLA to provide, verify, stake out final grade and new right of way. Due to construction limitations, timeframe and cost, all buried cable will be placed in conduit without Plant Betterment. All conduit and buried plant identified as removal will be abandon in place.

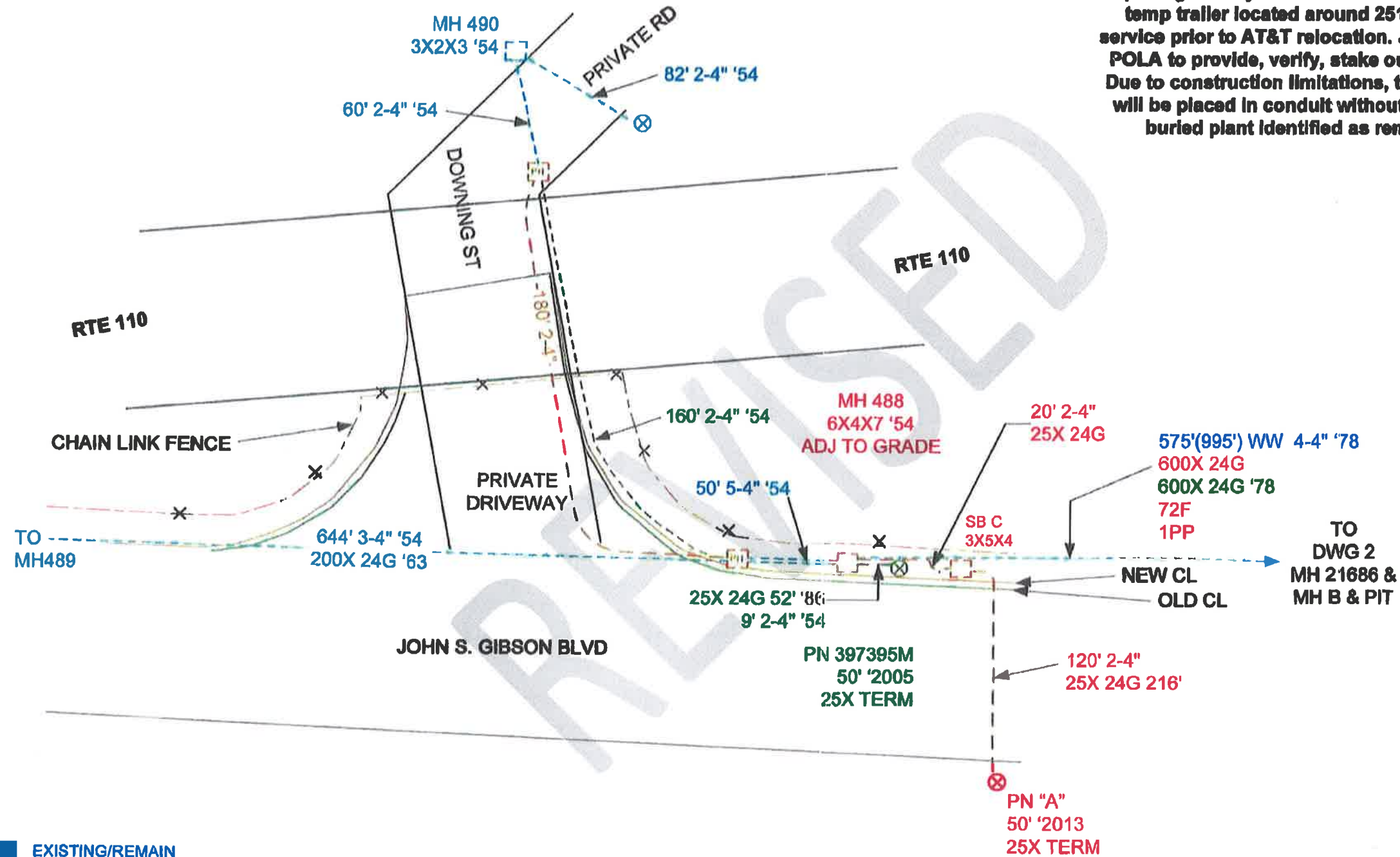

- EXISTING/REMAIN
- PROPOSED
- REMOVE/ABN

JPA PENDING LADWP
 T.G. 794 C-7
 REC. NO. C288, C35, C118

EXCH.	WILMGTON
GEO/CO:	A403
ENGR:	M.E.CORREA
TELEPHONE:	626 308-4072
ENGR ARC:	VOKDGO9L0
JOB TYPE:	CALTRANS RELOC
Job NO:	8702670
Change #	EA264801

DWG 1 OF 2 11-27-12

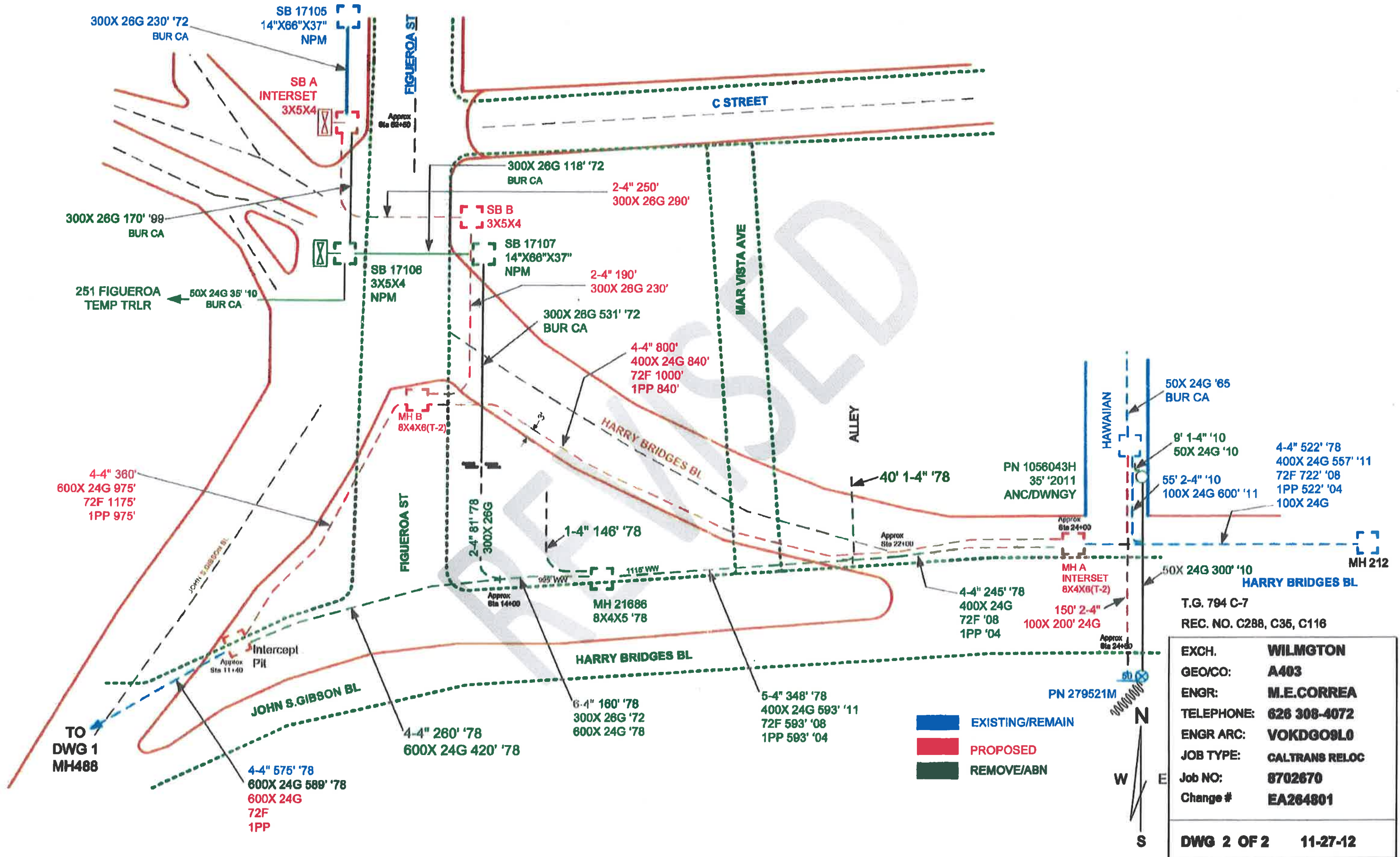

T.G. 794 C-7
 REC. NO. C288, C35, C116

EXCH.	WILMINGTON
GEO/CO:	A403
ENGR:	M.E. CORREA
TELEPHONE:	626 308-4072
ENGR ARC:	VOKDGO9L0
JOB TYPE:	CALTRANS RELOC
Job NO:	8702670
Change #	EA264801

DWG 2 OF 2 11-27-12

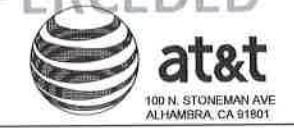

48 HOURS BEFORE YOU DIG CALL UNDERGROUND SERVICE ALERT of Southern California 1-800-422-4133

CONSTRUCTION REQUIREMENTS

- 1. MAINTAIN MINIMUM COVER OF 36" / 42" BELOW FLOW LINE. 2. VERIFY EXISTING SUBSTRUCTURES PRIOR TO EXCAVATION. 3. ALL 4" TO CONFORM TO PTS-77 OR EQUIVALENT. 4. ALL 2" TO CONFORM TO PTS-66 OR EQUIVALENT. 5. ALL BACKFILL TO BE SAND 12" BELOW AND 6" ABOVE. 6. DO NOT BACKFILL OVER ANY TELEPHONE BURIED SPLICE LOCATIONS UNTIL AUTHORIZED BY TELEPHONE COMPANY INSPECTOR. 7. PLACE # 6 TINNED GROUND WIRE AT BONDING POINTS (SEE BONDING DETAIL). 8. PLACE PULL ROPE IN NEW CONDUIT. 9. DO NOT CUT CURBS & GUTTERS. 10. ALL SURFACES AND LANDSCAPES WHICH HAVE BEEN REMOVED OR DAMAGED IN THE COURSE OF CONSTRUCTION SHALL BE RECONSTRUCTED OR REPLACED TO AT LEAST EQUAL OR BETTER THAN THE PREVIOUS OR ADJACENT SURFACE. 11. ALL TRAFFIC CONTROL TO BE IN ACCORDANCE WITH THE CALIFORNIA MANUAL ON UNIFORM TRAFFIC CONTROL DEVICES (MUTCD) LATEST EDITION. 12. PER AT&T GUIDELINES, ALL HANDHOLES, SPLICE BOXES, AND MANHOLES TO BE PURCHASED FROM EITHER NEWBASE OR UTILITY VAULT.

THIS PROJECT REQUIRES EXCAVATION. CONSTRUCTION WILL UTILIZE AND IMPLEMENT ALL BEST MANAGEMENT PRACTICES (BMP'S) AS REQUIRED TO ENSURE COMPLIANCE WITH AT&T POLICY LETTER ISSUE FEBRUARY 21, 2003 AND REVISED IN OCTOBER 2005 BY ENVIRONMENTAL MANAGEMENT CONCERNING STORM WATER PERMITTING AND STORM WATER POLLUTION PREVENTION PLANS (SWPPP) AND IN ACCORDANCE WITH THE CLEAN WATER ACT (1972) AND EPA REGULATIONS PUBLISHED IN 1990 AS MODIFIED BY THE PHASE II RULE IN 1999.

LOCATION: FIGUEROA ST. W/S OF STREET 17' SO C/L OF W. C. ST.

DESCRIPTION: PLACE MH "B" (T-16). PLACE 292' OF 4-4" DUCTS FROM MH "B" TO MH "C". PLACE MH "C" (T-16). PLACE 84' OF 4-4" DUCTS FROM MH "C". ABANDON BURIED CABLES. REMOVE SB # 17105 & SB # 17107.

BACKFILL SHALL BE SOIL CEMENT SLURRY OR OTHER MATERIAL IN CONFORMANCE WITH CITY ENGINEER'S SPECIAL ORDER No. 50-06-0182 DATED JANUARY 28, 1982. (CITY OF L.A.)

RECOMMENDATION FOR BACKFILL SPECIAL ORDER # 06-0182

Table with 3 columns: STREET TYPE, SOIL CLASS, PROPOSED BACKFILL. Rows include MAJOR, SECONDARY, LOCAL, ALLEY.

CONDUIT RECORD: A403C116 FIGUEROA ST. A403C288 JOHN S. GIBSON BLVD.

SUB MAP #: 27-20-B6 & 27-201-AA

STREET NAME N/A, MATERIAL N/A, LINEAR FEET N/A

EXCAVATION DATA

Table with 2 columns: CITY OF, PLACING. Rows include LOS ANGELES (HARBOR), UG CONDUIT & (2) T-16, EXCAVATION IN CONCRETE SIDEWALK, EXCAVATION IN ASPHALT STREET, EXCAVATION IN DIRT, EXCAVATION IN CONCRETE SIDEWALK (MH PIT), EXCAVATION IN DIRT (MH PIT), EXCAVATION IN CONCRETE SIDEWALK (T16).

TOTAL EXCAVATION: 406 SQ. FT. NUMBER OF CUTS: 4

Table with 4 columns: DATE, ATTD, TELEPHONE NUMBER, EMAIL ADDRESS. Rows include DRAWN, CHECKED, APPROVED.

Table with 2 columns: DATE, REVISIONS. Rows include 5/13/14, 6/5/14, 8/18/14.

SCALE: 1" = 20'. FILENAME: A403 8702670.dwg. DRAWING: 1/5

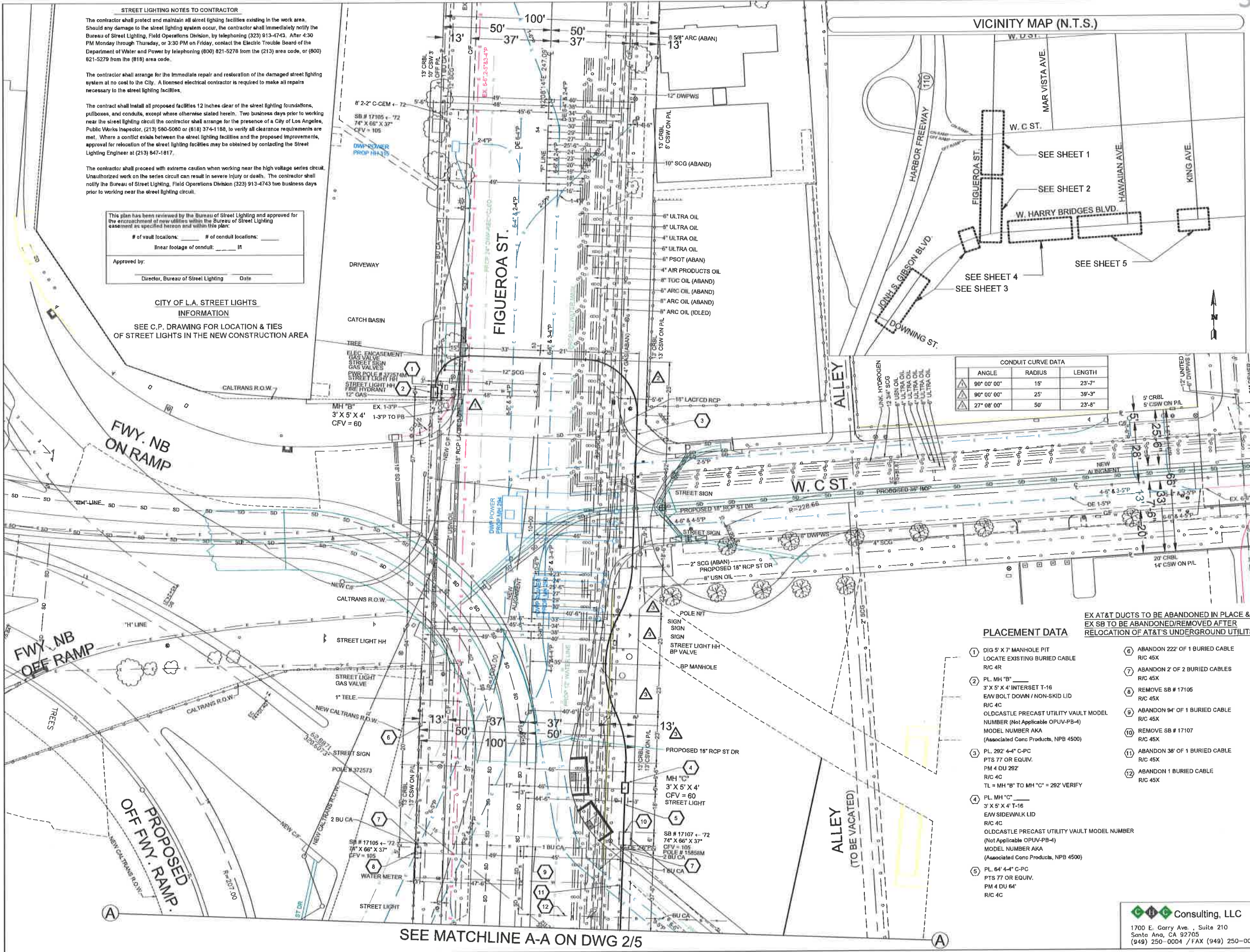

VICINITY MAP (N.T.S.)

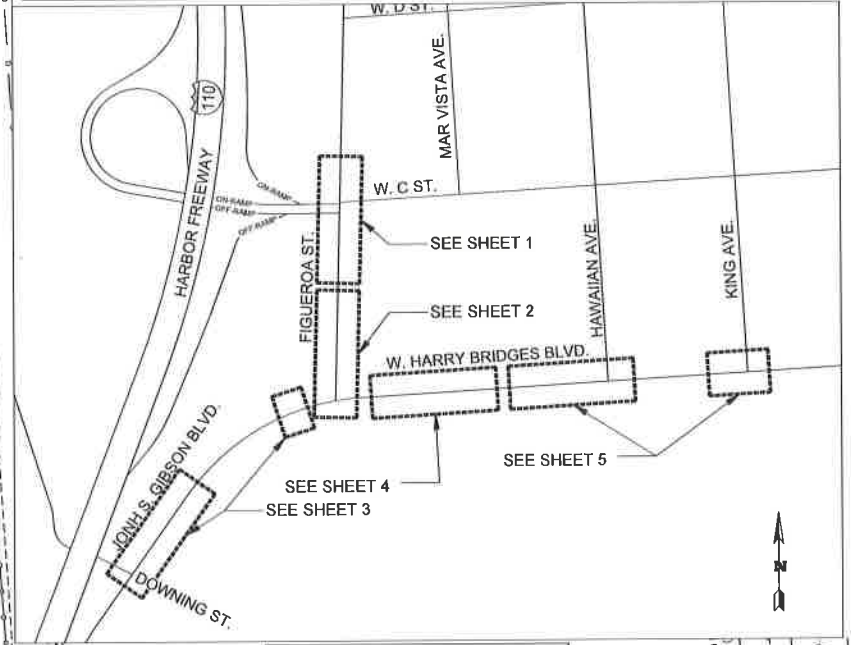

Table with 3 columns: ANGLE, RADIUS, LENGTH. Rows include 90° 00' 00", 27° 08' 00".

PLACEMENT DATA

- 1. DIG 5' X 7' MANHOLE PIT LOCATE EXISTING BURIED CABLE R/C 4R. 2. PL. MH "B" 3' X 5' X 4' INTERSET T-16. 3. PL. 292' 4-4" C-PC PTS 77 OR EQUIV. 4. PL. MH "C" 3' X 5' X 4' T-16. 5. PL. 84' 4-4" C-PC PTS 77 OR EQUIV. 6. ABANDON 222' OF 1 BURIED CABLE R/C 45X. 7. ABANDON 2' OF 2 BURIED CABLES R/C 45X. 8. REMOVE SB # 17105 R/C 45X. 9. ABANDON 94' OF 1 BURIED CABLE R/C 45X. 10. REMOVE SB # 17107 R/C 45X. 11. ABANDON 38' OF 1 BURIED CABLE R/C 45X. 12. ABANDON 1 BURIED CABLE R/C 45X.

EX AT&T DUCTS TO BE ABANDONED IN PLACE & EX SB TO BE ABANDONED/REMOVED AFTER RELOCATION OF AT&T'S UNDERGROUND UTILITIES

STREET LIGHTING NOTES TO CONTRACTOR. The contractor shall protect and maintain all street lighting facilities existing in the work area. Should any damage to the street lighting system occur, the contractor shall immediately notify the Bureau of Street Lighting, Field Operations Division, by telephoning (323) 913-4743.

The contract shall install all proposed facilities 12 inches clear of the street lighting foundations, pullboxes, and conduits, except where otherwise stated herein. Two business days prior to working near the street lighting circuit the contractor shall arrange for the presence of a City of Los Angeles Public Works Inspector.

This plan has been reviewed by the Bureau of Street Lighting and approved for the encroachment of new utilities within the Bureau of Street Lighting easement as specified herein and within this plan.

Approval form with fields for # of vault locations, # of conduit locations, linear footage of conduit, and Director signature.

CITY OF L.A. STREET LIGHTS INFORMATION. SEE C.P. DRAWING FOR LOCATION & TIES OF STREET LIGHTS IN THE NEW CONSTRUCTION AREA.

SEE MATCHLINE A-A ON DWG 2/5

Consulting, LLC. 1700 E. Garry Ave., Suite 210, Santa Ana, CA 92705. (949) 250-0004 / FAX (949) 250-0008

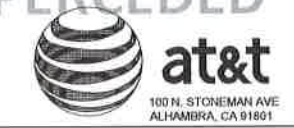

- CONSTRUCTION REQUIREMENTS**
1. MAINTAIN MINIMUM COVER OF 36" / 42" BELOW FLOW LINE.
 2. VERIFY EXISTING SUBSTRUCTURES PRIOR TO EXCAVATION.
 3. ALL 4" TO CONFORM TO PTS-77 OR EQUIVALENT.
 4. ALL 2" TO CONFORM TO PTS-66 OR EQUIVALENT.
 5. ALL BACKFILL TO BE SAND 12" BELOW AND 8" ABOVE.
 6. DO NOT BACKFILL OVER ANY TELEPHONE BURIED SPICE LOCATIONS UNTIL AUTHORIZED BY TELEPHONE COMPANY INSPECTOR.
 7. PLACE # 6 TINNED GROUND WIRE AT BONDING POINTS. (SEE BONDING DETAIL)
 8. PLACE PULL ROPE IN NEW CONDUIT.
 9. DO NOT CUT CURB & GUTTER.
 10. ALL SURFACES AND LANDSCAPES WHICH HAVE BEEN REMOVED OR DAMAGED IN THE COURSE OF CONSTRUCTION SHALL BE RECONSTRUCTED OR REPLACED TO AT LEAST EQUAL OR BETTER THAN THE PREVIOUS OR ADJACENT SURFACE.
 11. ALL TRAFFIC CONTROL TO BE IN ACCORDANCE WITH THE CALIFORNIA MANUAL ON UNIFORM TRAFFIC CONTROL DEVICES (MUTCD) LATEST EDITION.
 12. PER AT&T GUIDELINES, ALL HANDHOLES, SPLICE BOXES, AND MANHOLES TO BE PURCHASED FROM EITHER NEWBASE OR UTILITY VAULT.

THIS PROJECT REQUIRES EXCAVATION. CONSTRUCTION WILL UTILIZE AND IMPLEMENT ALL BEST MANAGEMENT PRACTICES (BMP'S) AS REQUIRED TO ENSURE COMPLIANCE WITH AT&T POLICY LETTER ISSUE FEBRUARY 21, 2003 AND REVISED IN OCTOBER 2005 BY ENVIRONMENTAL MANAGEMENT CONCERNING STORM WATER PERMITTING AND STORM WATER POLLUTION PREVENTION PLANS (SWPPP'S) AND IN ACCORDANCE WITH THE CLEAN WATER ACT (1972) AND EPA REGULATIONS PUBLISHED IN 1990 AS MODIFIED BY THE PHASE II RULE IN 1999.

LOCATION: FIGUEROA ST. E/S OF STREET 344' N/O C/L OF W. HARRY BRIDGES BLVD.

DESCRIPTION: PLACE 121' OF 2-4" DUCTS. PLACE MH "D" (T-2) PLACE 308' OF 4-4" DUCTS FROM MH "D". PLACE 267' OF 4-4" DUCTS. ABANDON BURIED CABLES. ABANDON 242' OF 4-4" DUCTS, 136' OF 6" DUCTS, 146' OF 1-4" DUCT & 22' OF 6-4" DUCTS.

BACKFILL SHALL BE SOIL CEMENT SLURRY OR OTHER MATERIAL IN CONFORMANCE WITH CITY ENGINEER'S SPECIAL ORDER No. SD-06-0182 DATED JANUARY 28, 1982. (CITY OF L.A.)

RECOMMENDATION FOR BACKFILL SPECIAL ORDER # 06-0182

STREET TYPE	SOIL CLASS	PROPOSED BACKFILL
MAJOR	N/A	N/A
SECONDARY	N/A	N/A
LOCAL	N/A	N/A
ALLEY	N/A	N/A

CONDUIT RECORD:
A403C288 JOHN S. GIBSON BLVD.

SUB MAP #: 27-201-AA

STREET NAME: N/A

MATERIAL: N/A

LINEAR FEET: N/A

EXCAVATION DATA

CITY OF:	LOS ANGELES (HARBOR)
PLACING:	UG CONDUITS & T-2

EXCAVATION IN	AREA	AREA (SQ FT)
EXCAVATION IN CONCRETE SIDEWALK	120' X 1' = 120 SQ FT	
EXCAVATION IN ASPHALT STREET	87' X 1' = 87 SQ FT	
EXCAVATION IN ASPHALT ALLEY		
EXCAVATION IN DIRT	254' X 1' = 254 SQ FT	
EXCAVATION IN ASPHALT	229' X 1' = 229 SQ FT	
EXCAVATION IN ASPHALT STREET (T-2)	8'-6" X 4'-6" = 38 SQ FT	
TOTAL EXCAVATION:		734 SQ FT

DATE	ATTID	LAYOUT ENGINEER
7/24/13	CHC / ES8397	TELEPHONE NUMBER
		EMAIL ADDRESS
		FAULTY ENGINEER
		TELEPHONE NUMBER
		FEDERAL OFFICE
		WILMINGTON

DATE REVISIONS

DATE	REV	BY	DESCRIPTION
5/13/14	REV 2	CHC / ES8397	REVISIONS
6/9/14	REV 3	CHC / ES8397	REVISIONS
6/18/14	REV 4	CHC / ES8397	REVISIONS

SCALE: 1" = 20'

FILENAME: A403 8702670.dwg

DRAWING: 2/5

Consulting, LLC
1700 E. Garry Ave., Suite 210
Santo Ana, CA 92705
(949) 250-0004 / FAX (949) 250-0006

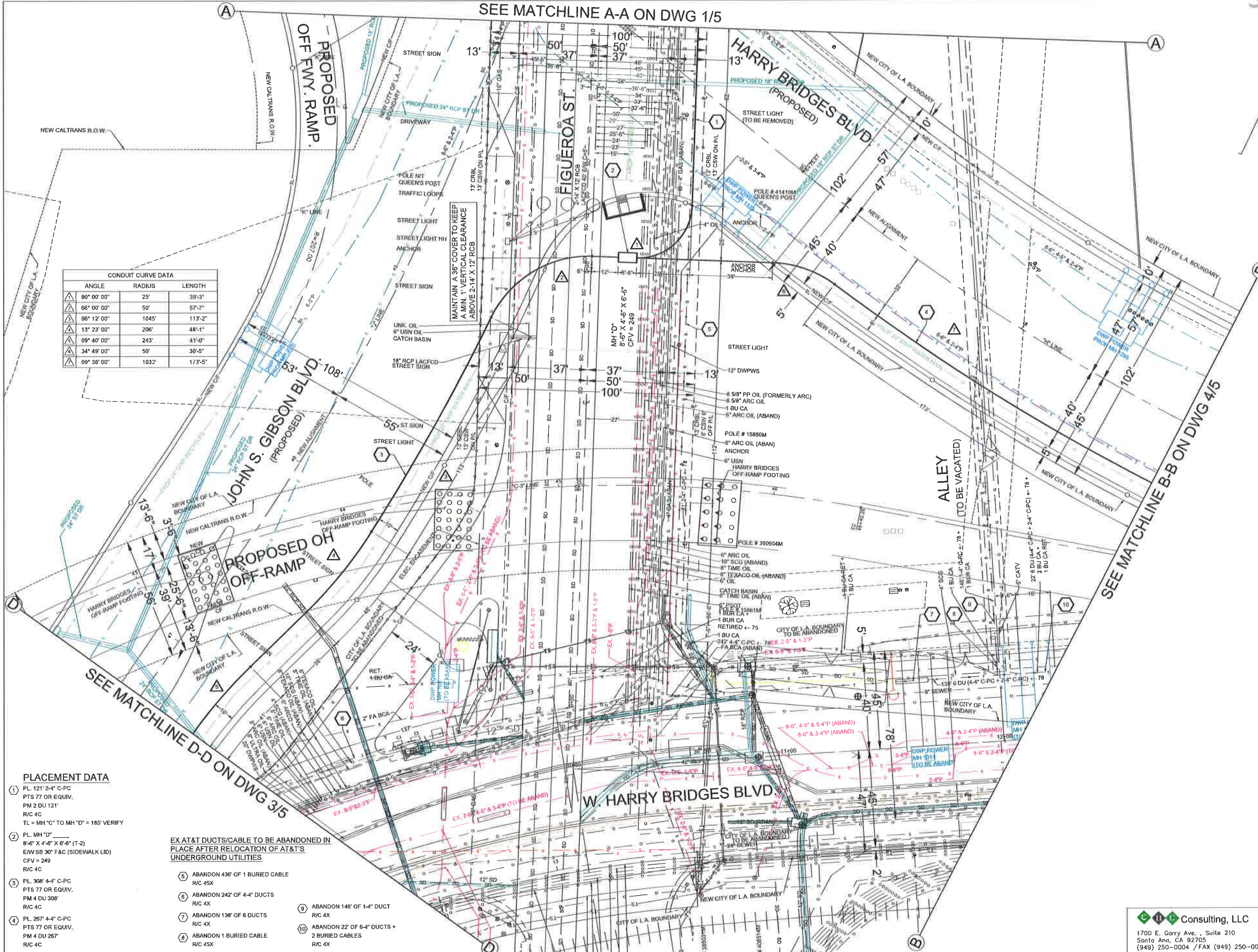

CONDUIT CURVE DATA

ANGLE	RADIUS	LENGTH
90° 00' 00"	25'	39'-3"
66° 00' 00"	50'	57'-7"
06° 12' 00"	1045'	113'-2"
13° 23' 00"	206'	48'-1"
09° 40' 00"	243'	41'-0"
34° 49' 00"	50'	30'-5"
09° 38' 00"	1032'	173'-5"

- PLACEMENT DATA**
1. PL 121' 2-4" C-PC
PTS 77 OR EQUIV.
PM 2 DU 121'
RIC 4C
TL = MH "C" TO MH "D" = 185' VERIFY
 2. PL MH "D"
8'-6" X 4'-6" X 6'-6" (T-2)
EW/SB 30" F&C (SIDEWALK LID)
CFV = 249
RIC 4C
 3. PL 308' 4-4" C-PC
PTS 77 OR EQUIV.
PM 4 DU 308'
RIC 4C
 4. PL 267' 4-4" C-PC
PTS 77 OR EQUIV.
PM 4 DU 267'
RIC 4C

EX AT&T DUCTS/CABLE TO BE ABANDONED IN PLACE AFTER RELOCATION OF AT&T'S UNDERGROUND UTILITIES

5. ABANDON 436' OF 1 BURIED CABLE
RIC 45X
6. ABANDON 242' OF 4-4" DUCTS
RIC 4X
7. ABANDON 136' OF 6 DUCTS
RIC 4X
8. ABANDON 1 BURIED CABLE
RIC 45X
9. ABANDON 146' OF 1-4" DUCT
RIC 4X
10. ABANDON 22' OF 6-4" DUCTS + 2 BURIED CABLES
RIC 4X

SEE MATCHLINE A-A ON DWG 1/5

SEE MATCHLINE B-B ON DWG 4/5

SEE MATCHLINE D-D ON DWG 3/5



CONSTRUCTION REQUIREMENTS

1. MAINTAIN MINIMUM COVER OF 36" / 42" BELOW FLOW LINE.
2. VERIFY EXISTING SUBSTRUCTURES PRIOR TO EXCAVATION.
3. ALL 4" TO CONFORM TO PTS.-77 OR EQUIVALENT.
4. ALL 2" TO CONFORM TO PTS.-66 OR EQUIVALENT.
5. ALL BACKFILL TO BE SAND 12" BELOW AND 6" ABOVE.
6. DO NOT BACKFILL OVER ANY TELEPHONE BURIED SPLICE LOCATIONS UNTIL AUTHORIZED BY TELEPHONE COMPANY INSPECTOR.
7. PLACE # 6 TINNED GROUND WIRE AT BONDING POINTS. (SEE BONDING DETAIL)
8. PLACE PULL ROPE IN NEW CONDUIT.
9. DO NOT CUT CURB & GUTTER.
10. ALL SURFACES AND LANDSCAPES WHICH HAVE BEEN REMOVED OR DAMAGED IN THE COURSE OF CONSTRUCTION SHALL BE RECONSTRUCTED OR REPLACED TO AT LEAST EQUAL OR BETTER THAN THE PREVIOUS OR ADJACENT SURFACE.
11. ALL TRAFFIC CONTROL TO BE IN ACCORDANCE WITH THE CALIFORNIA MANUAL ON UNIFORM TRAFFIC CONTROL DEVICES (MUTCD) LATEST EDITION.
12. PER AT&T GUIDELINES, ALL HANDHOLES, SPLICE BOXES, AND MANHOLES TO BE PURCHASED FROM EITHER NEWBASE OR UTILITY VAULT.

THIS PROJECT REQUIRES EXCAVATION. CONSTRUCTION WILL UTILIZE AND IMPLEMENT ALL BEST MANAGEMENT PRACTICES (BMP'S) AS REQUIRED TO ENSURE COMPLIANCE WITH AT&T POLICY LETTER ISSUE FEBRUARY 21, 2003 AND REVISED IN OCTOBER 2005 BY ENVIRONMENTAL MANAGEMENT CONCERNING STORM WATER PERMITTING AND STORM WATER POLLUTION PREVENTION PLANS (SWPPP'S) AND IN ACCORDANCE WITH THE CLEAN WATER ACT (1972) AND EPA REGULATIONS PUBLISHED IN 1990 AS MODIFIED BY THE PHASE II RULE IN 1999.

LOCATION: JOHN S. GIBSON BLVD. N/S OF STREET 191' W/O C/L OF FIGUEROA ST. & JOHN S. GIBSON BLVD. W/S OF STREET 78' N/O C/L OF DOWNING ST.

DESCRIPTION: WYE CAST EXISTING 4-4" DU & PLACE 85' OF 4-4" DU. PLACE POLE "A". PLACE 75' OF 2-4" DU FROM POLE "A" TO MH "E". PLACE MH "E" (1-16). PLACE 9' OF 2-4" DU FROM MH "E" TO MH # 488. ADJUST MH # 488 LID TO NEW GRADE. WYE CAST EX. 2 DU & PLACE 232' OF 2-4" DU, MAKING GOOD FROM MH # 488 TO MH # 490. ABANDON POLE # 397395M. ABANDON 8' & 204' OF 2 DU.

BACKFILL SHALL BE SOIL CEMENT SLURRY OR OTHER MATERIAL IN CONFORMANCE WITH CITY ENGINEER'S SPECIAL ORDER No. 60-06-0182 DATED JANUARY 28, 1982. (CITY OF L.A.)

RECOMMENDATION FOR BACKFILL SPECIAL ORDER # 06-0182

STREET TYPE	SOIL CLASS	PROPOSED BACKFILL
MAJOR	N/A	N/A
SECONDARY	N/A	N/A
LOCAL	N/A	N/A
ALLEY	N/A	N/A

CONDUIT RECORD:	
A403C286 JOHN S. GIBSON BLVD.	
A403C289 JOHN S. GIBSON BLVD.	
SUB MAP #:	27-201-AA, 27-201-SE & 27-201-SW
STREET NAME:	N/A
MATERIAL:	N/A
LINEAR FEET:	N/A

EXCAVATION DATA	
CITY OF:	LOS ANGELES (HARBOR)
PLACING:	UG CONDUITS, T-16 & POLE
EXCAVATION IN CONCRETE SIDEWALK	24' X 1' = 24 SQ FT
EXCAVATION IN ASPHALT STREET	127' X 1' = 127 SQ FT
EXCAVATION IN ASPHALT	72' X 1' = 72 SQ FT
EXCAVATION IN DIRT	3' X 1' = 3 SQ FT
EXCAVATION IN ASPHALT (2-SPLICE PITS)	4' X 4' = 32 SQ FT
EXCAVATION IN ASPHALT (T-16)	3' X 9' = 16 SQ FT
EXCAVATION IN CONCRETE SIDEWALK (POLE)	2' X 2' = 4 SQ FT
TOTAL EXCAVATION:	277 SQ FT
CITY OF:	PUE EASEMENT
PLACING:	UG CONDUITS
EXCAVATION IN ASPHALT STREET	172' X 1' = 172 SQ FT
EXCAVATION IN ASPHALT STREET (SPLICE PIT)	4' X 4' = 16 SQ FT
TOTAL EXCAVATION:	188 SQ FT
NUMBER OF CUTS:	9

DATE	ATTID	BY/CHK
7/24/13	CHC / ES8397	TELEPHONE NUMBER
		EMAIL ADDRESS
		FACILITY ENGINEER
		ALLEN LEE
		TELEPHONE NUMBER
		626-817-4235
DATE REVISIONS		
5/14/14	REV 2 - CHC / ES8397	ISSUES
		A4-03
6/5/14	REV 3 - CHC / ES8397	CENTRAL OFFICE
		WILMINGTON
6/18/14	REV 4 - CHC / ES8397	UNDERGROUND CONSTRUCTION PROJECT NUMBER
		8702670
SCALE:	1" = 20'	FILENAME:
		A403 8702670.dwg
		DRAWING:
		3/5

PLACEMENT DATA

1. DIG 4' X 4' SPLICE PIT R/C 4C
2. INTERCEPT 4 OF 4 EXISTING 4" DUCTS WITH WYE CASTING, MAKING GOOD FROM MH "D" TO MH # 488 R/C 4C
3. PL. 85' 4-4" C-PC PTS 77 OR EQUIV. PM 4 DU 85' R/C 4C TL = MH "D" TO MH # 488 = 917' VERIFY H POLE
4. PLACE NEW H-ALL 50' H POLE R/C 1C
5. PL. 75' 2-4" C-PC PTS 77 OR EQUIV. PM 2 DU 75' R/C 4C
6. PL. MH "E" 3' X 5' X 4' T-16 EW BOLT DOWN / NON-SKID LID R/C 4C OLDCASTLE PRECAST UTILITY VAULT MODEL NUMBER (Not Applicable OPUV-PB-4) MODEL NUMBER AKA (Associated Conc Products, NPB 4500)
7. PL. 9' 2-4" C-PC PTS 77 OR EQUIV. PM 2 DU 9' R/C 4C
8. ADJUST MH # 488 LID TO NEW GRADE R/C 4C
9. INTERCEPT 2 OF 5 EXISTING DUCTS WITH WYE CASTING, MAKING GOOD FROM MH # 488 TO MH # 490 R/C 4C
10. PL. 232' 2-4" C-PC PTS 77 OR EQUIV. PM 2 DU 232' R/C 4C TL = MH # 488 TO MH # 490 = 285' VERIFY TRENCH @ 42" COVER
11. INTERCEPT 2 OF 2 EXISTING DUCTS WITH WYE CASTING, MAKING GOOD FROM MH # 488 TO MH # 490 R/C 4C

EX AT&T DUCTS & POLE TO BE ABANDONED IN PLACE AFTER RELOCATION OF AT&T UNDERGROUND UTILITIES

12. ABANDON POLE # 397395M R/C 1X
13. ABANDON 8' OF 2 DUCTS R/C 4X
14. ABANDON 204' OF 2 DUCTS R/C 4X

CONDUIT CURVE DATA		
ANGLE	RADIUS	LENGTH
23° 43' 00"	25'	10'-4"
90° 00' 00"	10'	15'-8"
36° 52' 00"	5'	3'-3"
85° 18' 00"	35'	52'-1"
54° 18' 00"	15'	14'-3"

Consulting, LLC
1700 E. Garry Ave., Suite 210
Santa Ana, CA 92705
(949) 250-0004 / FAX (949) 250-0006



CONSTRUCTION REQUIREMENTS

1. MAINTAIN MINIMUM COVER OF 36" / 42" BELOW FLOW LINE.
2. VERIFY EXISTING SUBSTRUCTURES PRIOR TO EXCAVATION.
3. ALL 4" TO CONFORM TO PITS -77 OR EQUIVALENT.
4. ALL 2" TO CONFORM TO PITS -68 OR EQUIVALENT.
5. ALL BACKFILL TO BE SAND 12" BELOW AND 6" ABOVE.
6. DO NOT BACKFILL OVER ANY TELEPHONE BURIED SPICE LOCATIONS UNTIL AUTHORIZED BY TELEPHONE COMPANY INSPECTOR.
7. PLACE # 6 TINNED GROUND WIRE AT BONDING POINTS. (SEE BONDING DETAIL)
8. PLACE PULL ROPE IN NEW CONDUIT.
9. DO NOT CUT CURB & GUTTER.
10. ALL SURFACES AND LANDSCAPES WHICH HAVE BEEN REMOVED OR DAMAGED IN THE COURSE OF CONSTRUCTION SHALL BE RECONSTRUCTED OR REPLACED TO AT LEAST EQUAL OR BETTER THAN THE PREVIOUS OR ADJACENT SURFACE.
11. ALL TRAFFIC CONTROL TO BE IN ACCORDANCE WITH THE CALIFORNIA MANUAL ON UNIFORM TRAFFIC CONTROL DEVICES (MUTCD) LATEST EDITION.
12. PER AT&T GUIDELINES, ALL HANDHOLES, SPICE BOXES, AND MANHOLES TO BE PURCHASED FROM EITHER NEWBASE OR UTILITY VAULT.

THIS PROJECT REQUIRES EXCAVATION. CONSTRUCTION WILL UTILIZE AND IMPLEMENT ALL BEST MANAGEMENT PRACTICES (BMP'S) AS REQUIRED TO ENSURE COMPLIANCE WITH AT&T POLICY LETTER ISSUE FEBRUARY 21, 2003 AND REVISED IN OCTOBER 2005 BY ENVIRONMENTAL MANAGEMENT CONCERNING STORM WATER PERMITTING AND STORM WATER POLLUTION PREVENTION PLANS (SWPPP'S) AND IN ACCORDANCE WITH THE CLEAN WATER ACT (1972) AND EPA REGULATIONS PUBLISHED IN 1990 AS MODIFIED BY THE PHASE II RULE IN 1999.

LOCATION: W. HARRY BRIDGES BLVD N/S OF STREET 333' E/O CL OF MAR VISTA AVE.

DESCRIPTION: PLACE 472' OF 4-4" DUCTS. ABANDON MH # 21686. ABANDON BURIED CABLES. ABANDON 4' OF 5-4" DUCTS, 348' OF 5-4" DUCTS, 40' OF 1-4" DUCT & 172' OF 4-4" DUCTS.

BACKFILL SHALL BE SOIL CEMENT SLURRY OR OTHER MATERIAL IN CONFORMANCE WITH CITY ENGINEER'S SPECIAL ORDER No. SO-06-0182 DATED JANUARY 28, 1982. (CITY OF L.A.)

RECOMMENDATION FOR BACKFILL SPECIAL ORDER # 06-0182

STREET TYPE	SOIL CLASS	PROPOSED BACKFILL
MAJOR	N/A	N/A
SECONDARY	N/A	N/A
LOCAL	N/A	N/A
ALLEY	N/A	N/A

STREET NAME	MATERIAL	LINEAR FEET
N/A	N/A	N/A
N/A	N/A	N/A
N/A	N/A	N/A

EXCAVATION DATA	
CITY OF:	LOS ANGELES (HARBOR)
PLACING:	UG CONDUITS

EXCAVATION IN CONCRETE SIDEWALK:	36' X 1" = 36 SQ FT
EXCAVATION IN ASPHALT STREET:	299' X 1" = 299 SQ FT
EXCAVATION IN ASPHALT ALLEY:	
EXCAVATION IN DIRT:	137' X 1" = 137 SQ FT

TOTAL EXCAVATION:	472 SQ FT
NUMBER OF CUTS:	1

DATE	ATTID	TELEPHONE NUMBER
7/24/13	CHC / E58397	

DATE	REVISIONS
5/13/14	REV 2 - CHC / E58397
9/5/14	REV 3 - CHC / E58397
8/18/14	REV 4 - CHC / E58397

SCALE:	1" = 20'	824-C1 & D1
FILENAME:	A403 8702670.dwg	8702670
DRAWING:		4/5

PLACEMENT DATA
 ① PL 472' 4-4" C-PC
 PTS 77 OR EQUIV.
 PM 4 DU 472'
 R/C 4C
 TL = MH "D" TO MH "F" = 738' VERIFY

EX AT&T DUCTS/CABLE TO BE ABANDONED IN PLACE AFTER RELOCATION OF AT&T'S UNDERGROUND UTILITIES

- ② ABANDON MH # 21686
R/C 4X
- ③ ABANDON 4' OF 5-4" DUCTS +
1 BUR CA
R/C 4X
- ④ ABANDON 1 BURIED CABLE
R/C 45X
- ⑤ ABANDON 348' OF 5-4" DUCTS
R/C 4X
- ⑥ ABANDON 40' OF 1-4" DUCT
R/C 4X
- ⑦ ABANDON 172' OF 4-4" DUCTS
R/C 4X

CONDUIT CURVE DATA

ANGLE	RADIUS	LENGTH
△ 03° 45' 00"	545'	35'-8"
△ 12° 28' 00"	100'	21'-8"
△ 25° 13' 00"	100'	44'-0"
△ 14° 23' 00"	100'	25'-1"

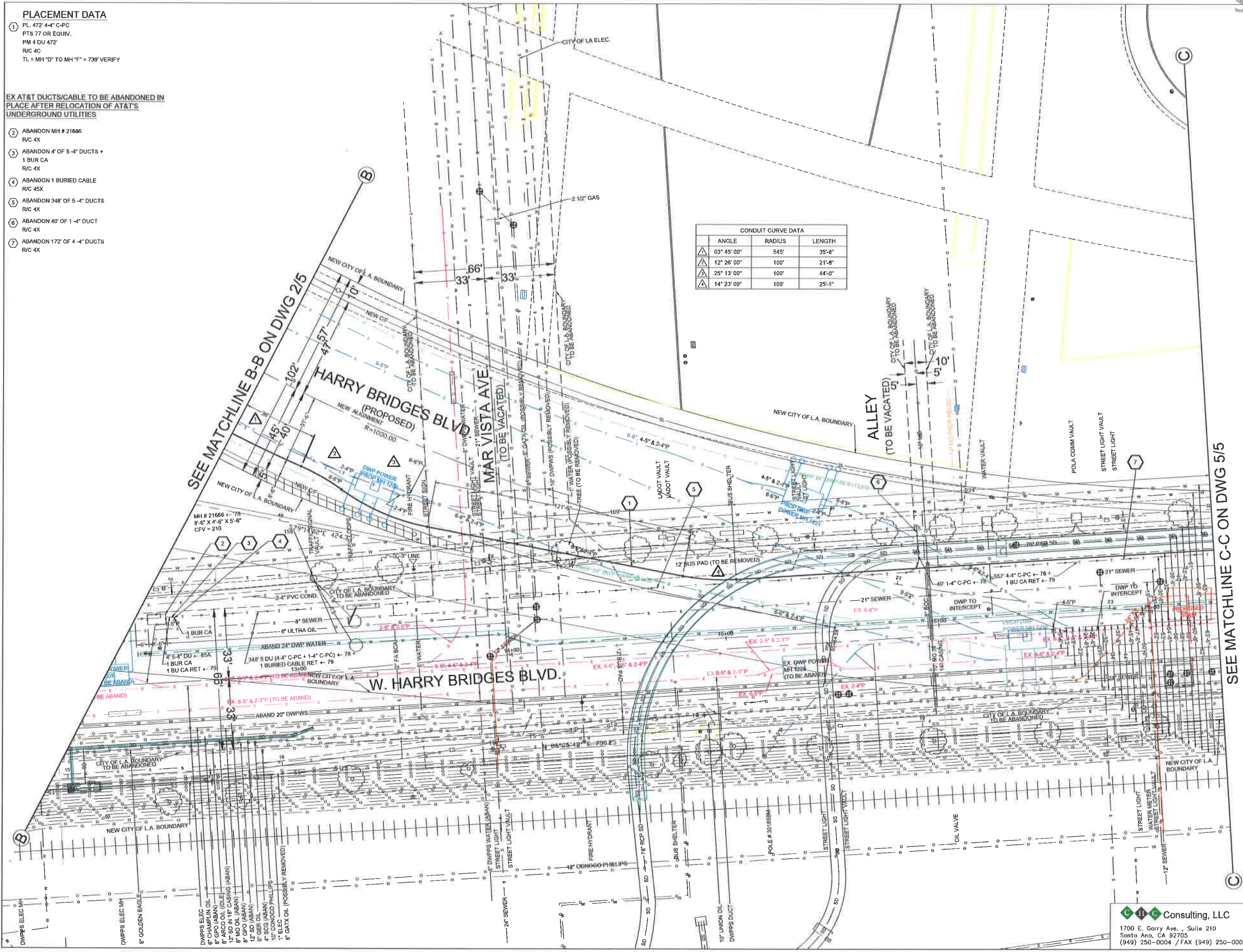

Consulting, LLC
 1700 E. Garry Ave., Suite 210
 Santa Ana, CA 92705
 (949) 250-0004 / FAX (949) 250-0006



100 N. STONEMAN AVE
ALHAMBRA, CA 91801



CONSTRUCTION REQUIREMENTS

1. MAINTAIN MINIMUM COVER OF 36" / 42" BELOW FLOW LINE.
2. VERIFY EXISTING SUBSTRUCTURES PRIOR TO EXCAVATION.
3. ALL 4" TO CONFORM TO PTS.-77 OR EQUIVALENT.
4. ALL 2" TO CONFORM TO PTS.-66 OR EQUIVALENT.
5. ALL BACKFILL TO BE SAND 12" BELOW AND 6" ABOVE.
6. DO NOT BACKFILL OVER ANY TELEPHONE BURIED SPLICE LOCATIONS UNTIL AUTHORIZED BY TELEPHONE COMPANY INSPECTOR.
7. PLACE # 6 TINNED GROUND WIRE AT BONDING POINTS. (SEE BONDING DETAIL)
8. PLACE PULL ROPE IN NEW CONDUIT.
9. DO NOT CUT CURBS & GUTTER.
10. ALL SURFACES AND LANDSCAPES WHICH HAVE BEEN REMOVED OR DAMAGED IN THE COURSE OF CONSTRUCTION SHALL BE RECONSTRUCTED OR REPLACED TO AT LEAST EQUAL OR BETTER THAN THE PREVIOUS OR ADJACENT SURFACE.
11. ALL TRAFFIC CONTROL TO BE IN ACCORDANCE WITH THE CALIFORNIA MANUAL ON UNIFORM TRAFFIC CONTROL DEVICES (MUTCD) LATEST EDITION.
12. PER AT&T GUIDELINES, ALL HANDHOLES, SPLICE BOXES, AND MANHOLES TO BE PURCHASED FROM EITHER NEWBASE OR UTILITY VAULT.

THIS PROJECT REQUIRES EXCAVATION. CONSTRUCTION WILL UTILIZE AND IMPLEMENT ALL BEST MANAGEMENT PRACTICES (BMP'S) AS REQUIRED TO ENSURE COMPLIANCE WITH AT&T POLICY LETTER ISSUE FEBRUARY 21, 2003 AND REVISED IN OCTOBER 2005 BY ENVIRONMENTAL MANAGEMENT CONCERNING STORM WATER PERMITTING AND STORM WATER POLLUTION PREVENTION PLANS (SWPPP'S) AND IN ACCORDANCE WITH THE CLEAN WATER ACT (1972) AND EPA REGULATIONS PUBLISHED IN 1990 AS MODIFIED BY THE PHASE II RULE IN 1999.

LOCATION: W. HARRY BRIDGES BLVD. N/S OF STREET 35' W/O CIL OF HAWAIIAN AVE. & HAWAIIAN AVE. E/S OF STREET 74' N/O CIL OF W. HARRY BRIDGES AVE.

DESCRIPTION: PLACE MH "F" (T-2) PLACE 20' OF 4"-4" DUCTS TO MH "F". PLACE 158' OF 2"-4" DUCTS FROM MH "A" TO POLE # 279521M.

BACKFILL SHALL BE SOIL CEMENT SLURRY OR OTHER MATERIAL IN CONFORMANCE WITH CITY ENGINEER'S SPECIAL ORDER NO. 50-06-0182 DATED JANUARY 28, 1982. (CITY OF L.A.)

RECOMMENDATION FOR BACKFILL (SPECIAL ORDER # 06-0182)

STREET TYPE	SOIL CLASS	PROPOSED BACKFILL
MAJOR	N/A	N/A
SECONDARY	N/A	N/A
LOCAL	N/A	N/A
ALLEY	N/A	N/A

CONDUIT RECORD: A403C35 HARRY BRIDGES BLVD.	<p>N</p>
SUB MAP #: 27-201-AC	
STREET NAME: N/A	
MATERIAL: N/A	
LINEAR FEET: N/A	

EXCAVATION DATA	
CITY OF:	LOS ANGELES (HARBOR)
PLACING:	UG CONDUITS & T-2
EXCAVATION IN CONCRETE SIDEWALK:	20' X 1' = 20 SQ FT
EXCAVATION IN ASPHALT STREET:	104' X 1' = 104 SQ FT
EXCAVATION IN DIRT:	17' X 1' = 17 SQ FT
EXCAVATION IN ASPHALT STREET (T-2 MH PIT):	6'-6" X 10'-6" = 68 SQ FT
TOTAL EXCAVATION:	209 SQ FT
CITY OF:	PRIVATE PROPERTY:
PLACING:	UG CONDUITS
EXCAVATION IN DIRT:	34' X 1' = 34 SQ FT
TOTAL EXCAVATION:	34 SQ FT
NUMBER OF CUTS:	3

DATE	ATTID	DATE	ATTID	DATE	ATTID
DRAWN	7/24/13	CHC / ES8397			
CHECKED					
APPROVED					

DATE	REVISIONS	DATE	ATTID
5/13/14	REV 2 - CHC / ES8397		
6/5/14	REV 3 - CHC / ES8397		
6/18/14	REV 4 - CHC / ES8397		

Consulting, LLC
1700 E. Garry Ave., Suite 210
Santa Ana, CA 92705
(949) 250-0004 / FAX (949) 250-0008

SCALE:	1" = 20'	PROJECT NUMBER:	8702670
FILENAME:	A403 8702670.dwg	DRAWING:	5/5

PLACEMENT DATA

1. DIG 6'-6" X 10'-6" MANHOLE PIT
LOCATE EXISTING 4"-4" DUCTS
R/C 4R
2. PL. MH "F"
8'-6" X 4'-6" X 6'-6" INTERSET T-2
EMV SB 30" F&C (STREET LID)
CFV = 249
R/C 4C
3. PL. 20' 4"-4" C-PC
PTS 77 OR EQUIV.
PM 4 DU 20"
R/C 4C
TL = MH "D" TO MH "F" = 767' VERIFY
4. PL. 158' 2"-4" C-PC
PTS 77 OR EQUIV.
PM 2 DU 158"
R/C 4C

CONDUIT CURVE DATA		
ANGLE	RADIUS	LENGTH
90° 00' 00"	12'-6"	19'-8"

SEE MATCHLINE C-C ON DWG 4/5

