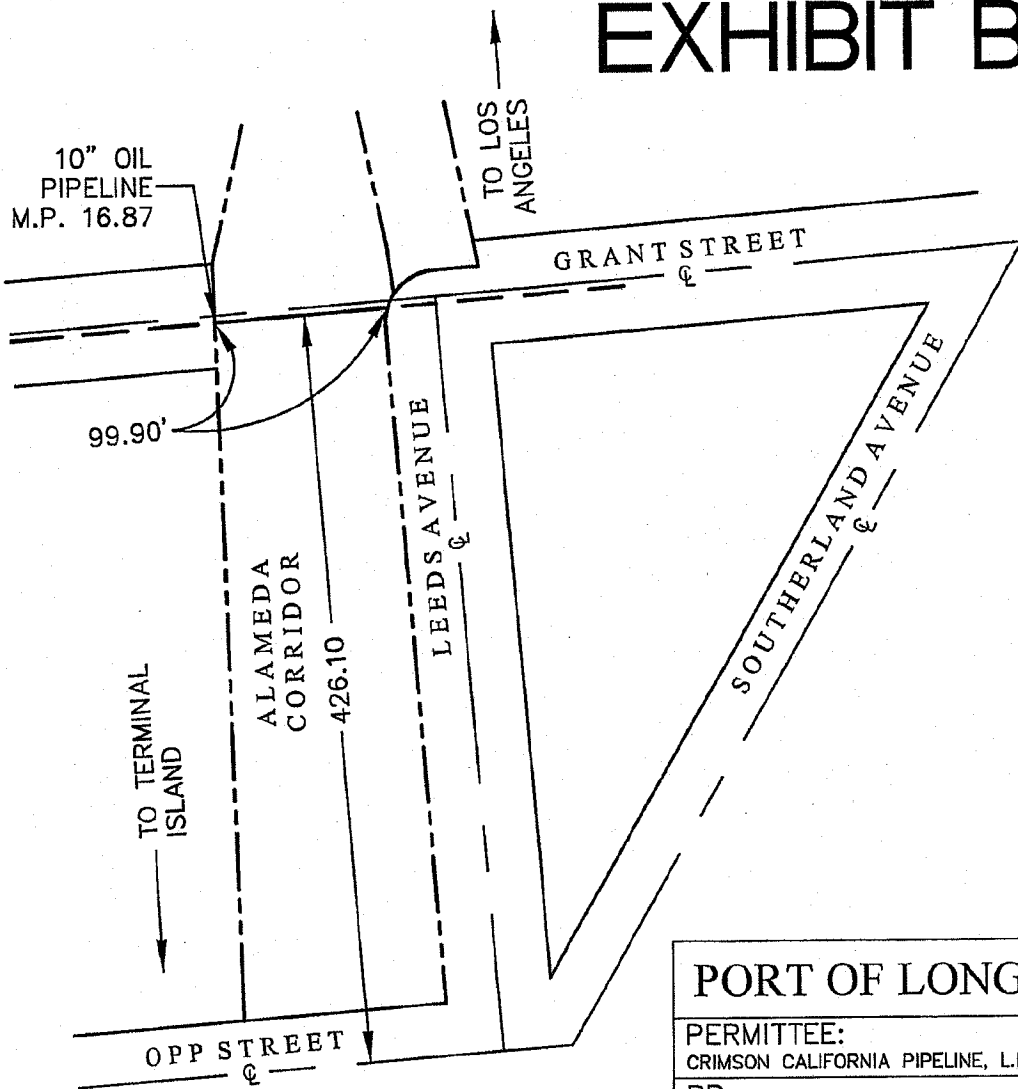
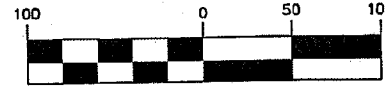

EXHIBIT B-1



GRAPHIC SCALE



(IN FEET)
1 inch = 100 ft.

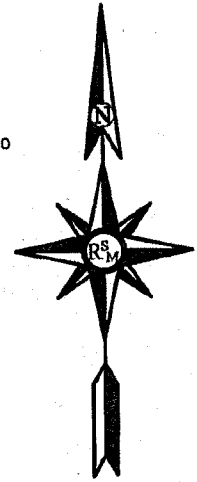

LEGEND	
CITIES R/W LINE	-----
FACILITY INSIDE CITIES' R/W	=====
FACILITY OUTSIDE CITIES' R/W	-----
STREET R/W LINE	=====
STREET CENTERLINE	-----

PORT OF LONG BEACH/PORT OF LOS ANGELES

PERMITTEE: CRIMSON CALIFORNIA PIPELINE, L.P.	LENGTH: 99.90'		
RR: ALAMEDA CORRIDOR	WIDTH: 5.00'		
MP: 16.87	SQUARE FEET: 499.50'		
CITY: WILMINGTON	COUNTY: LOS ANGELES	PAGE: 1 OF 1	
SCALE: AS SHOWN	THOMAS GUIDE: 794-H5	DATE: 5-6-2014	PREPARED BY: RSM



**ROSELL SURVEYING
AND MAPPING, INC.**
LAND SURVEYING, MAPPING, & GIS
15180 Transistor Lane, Huntington Beach, California 92648
Ph. (714)934-4500 Fax (714)934-4544 www.RosellSurveying.com
Info@RosellSurveying.com

EXHIBIT B-2

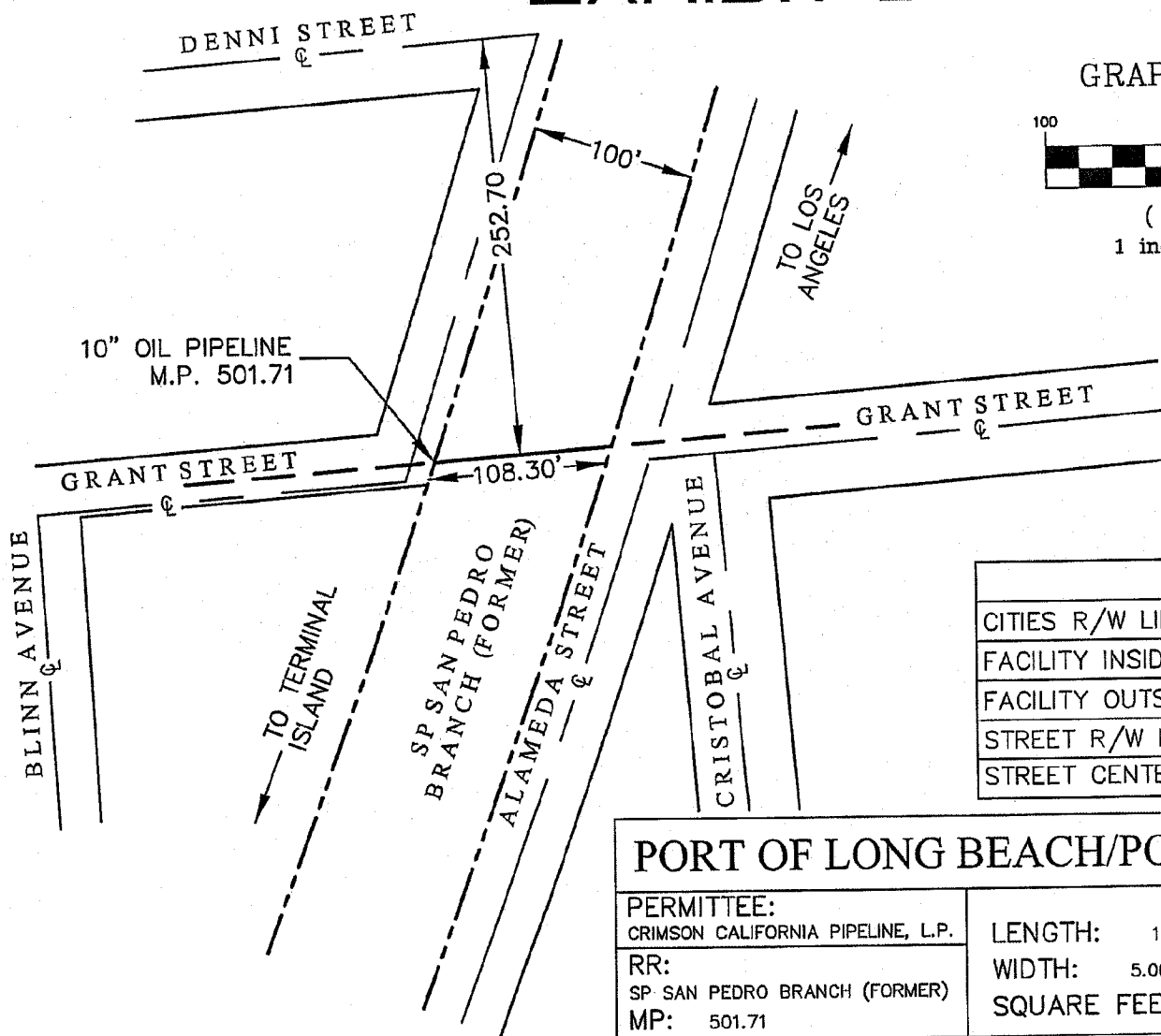

GRAPHIC SCALE



(IN FEET)
1 inch = 100 ft.

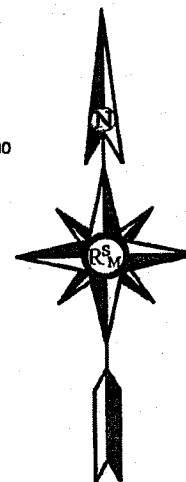

LEGEND	
CITIES R/W LINE	-----
FACILITY INSIDE CITIES' R/W	=====
FACILITY OUTSIDE CITIES' R/W	-----
STREET R/W LINE	=====
STREET CENTERLINE	-----

PORT OF LONG BEACH/PORT OF LOS ANGELES

PERMITTEE: CRIMSON CALIFORNIA PIPELINE, L.P.	LENGTH: 108.30'	PAGE: 1 OF 1
RR: SP SAN PEDRO BRANCH (FORMER)	WIDTH: 5.00'	
MP: 501.71	SQUARE FEET: 541.50'	
CITY: WILMINGTON	COUNTY: LOS ANGELES	
SCALE: AS SHOWN	THOMAS GUIDE: 794-G5	DATE: 5-6-2014
		PREPARED BY: RSM



**ROSELL SURVEYING
AND MAPPING, INC.**
LAND SURVEYING, MAPPING, & GIS
15180 Transador Lane, Huntington Beach, California 92649
Ph. (714)934-4500 Fax (714)934-4544 www.RosellSurveying.com
Info@RosellSurveying.com